



HYBRID
WHOLE HOME
POWERLINE
WI-FI SYSTEM



HYBRID
WHOLE HOME
POWERLINE
WI-FI SYSTEM





Covr your Whole Home in **Seamless Wi-Fi**

Covr uses your home's existing electrical wiring to send network data throughout your home, reaching dead spots and far away areas without any degradation of signal or speed. Covr Hybrid Powerline Wi-Fi extenders then send network data to your wireless devices using high speed AC1200 Wi-Fi or to wired devices through three on-board Gigabit Ethernet ports.



HIGH PERFORMANCE

With 1,300 Mbps AV2.1 and MIMO technologies at its core, Covr Hybrid Whole Home Powerline Wi-Fi System provides a dedicated Powerline backbone that delivers lightning fast speed, perfect for gaming and 4K video streaming.



MORE COVERAGE

Through the hybrid technology of a dedicated Powerline backbone and Wi-Fi combined, Covr provides seamless coverage for the most robust home network possible. If you need additional coverage, just add more Covr Hybrid Powerline Wi-Fi extenders.



ONE SEAMLESS NETWORK

With Covr, there's just one wireless network name (SSID) for your entire home, no matter where you are.



Hybrid Powerline Wi-Fi Technology

D-Link's Covr Hybrid Whole Home Powerline Wi-Fi System is the only solution to offer users the option to use Powerline to create a whole-home network. The hybrid technology utilizes a home's existing electrical wiring to transfer data through a dedicated backhaul at high speeds.

D-Link's two-piece Hybrid Whole Home Powerline Wi-Fi System works in tandem with users' existing home router to create a whole home network using an AV2.1 1,300 Mbps Powerline backbone and AC1200 Wi-Fi.



SIMPLY PLUG IN AND GO

Setup up in seconds with plug and play installation. No technical knowledge needed.



WORKS WITH EXISTING ROUTER

Simply connect to your home router to add seamless whole home Wi-Fi to your existing network.





Smart Roaming



Gone are the days of only being able to use Wi-Fi in certain areas of your home: Seamless roaming lets you move around the house while always being connected to the **strongest signal** available. Forget about traditional Wi-Fi extenders which require you to connect to different networks as you move around, Covr ensures your entire home is covered by a **single, seamless network**.

Having **one Wi-Fi name** (SSID) means once you connect, your connection is seamlessly maintained as you and your wireless devices roam around your home. As you move from room to room and floor to floor you'll experience uninterrupted Wi-Fi. Buffering, drop-outs and deadspots are now a thing of the past.

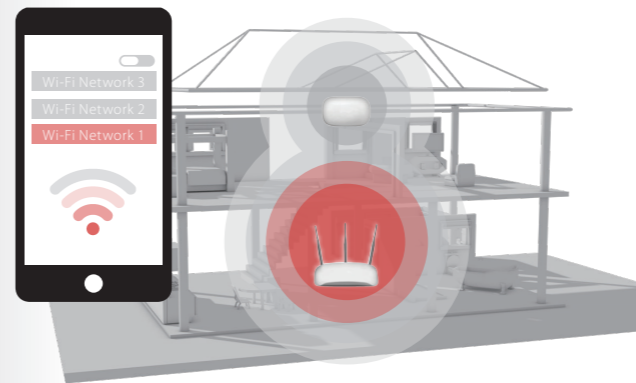

Traditional Router + Extender Systems



Covr Whole Home Powerline Wi-Fi System



Wi-Fi Without Compromise



Covr responds to the need for speed as consumers use more and more Wi-Fi connected devices. Data-intensive activities like streaming 4K video, online gaming, and intense downloading mean a high-speed Wi-Fi connection is essential in the modern home.

High Speed Hybrid Technology



Most whole home Wi-Fi systems use multiple low-performance access points to disperse Wi-Fi throughout areas of the home. Covr's unique hybrid Powerline Wi-Fi technology combines ultra-fast 1300 Mbps AV2.1, MIMO and AC1200 Wi-Fi together with your existing router to create a seamless whole home network of blazing fast speed throughout your home, even in the most hard-to-reach places.

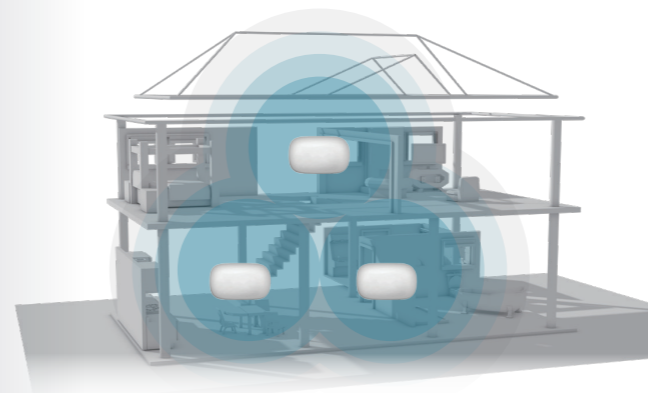

Other Whole Home Wi-Fi Systems

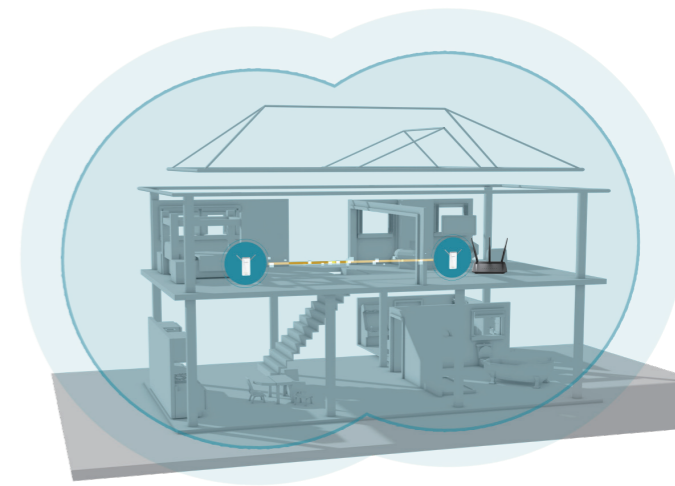

Covr Whole Home Wi-Fi System

HYBRID TECHNOLOGY

Unleash your Wi-Fi's Full Potential



MU-MIMO Technology



Like having multiple routers in your home, Multi-User MIMO (MU-MIMO) sends data to multiple devices simultaneously to increase speed and efficiency. Your laptop, tablet, media player and game console can all receive data at the same time, with no need to wait in turn, allowing you to get more out of your home Wi-Fi network than ever before.

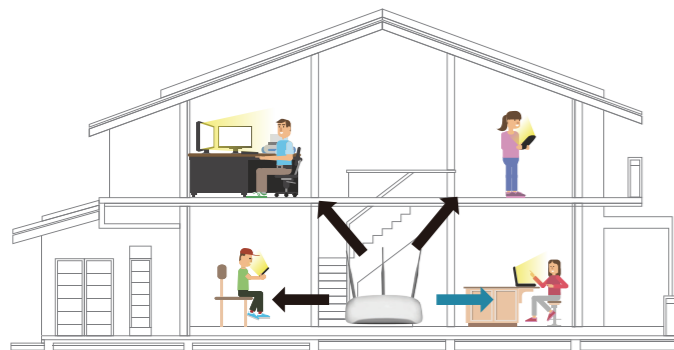

Traditional Wi-Fi

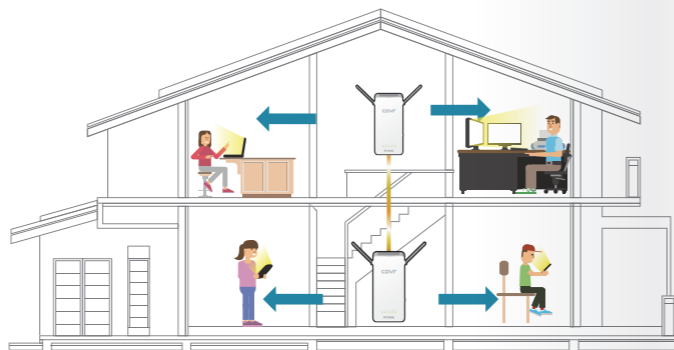

Covr with MU-MIMO

Smart Steering



If you don't know your 2.4's from your 5's, don't worry. Smart steering selects the best band for your device so that you get the best performance possible – all the time. With smart steering, Covr will automatically connect devices to the optimal Wi-Fi band and even move devices between Wi-Fi bands when the network experiences congestion. All this without dropouts, lag or any interruption to your wireless connection; and most importantly without you lifting a finger.

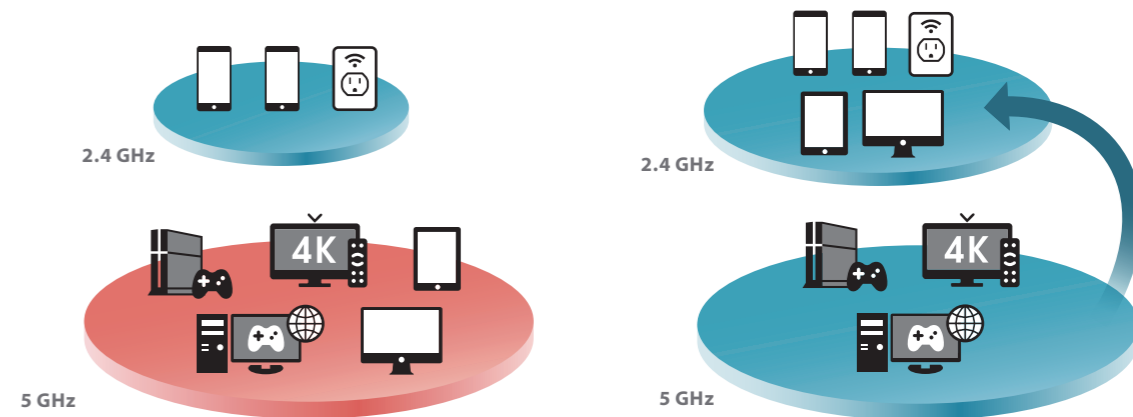

Traditional Dual-band Wi-Fi

High network traffic on the 5 GHz band causes congestion and slows down devices

Covr with Smart Steering

Some devices automatically shift to the 2.4 GHz band to balance network traffic and reduce congestion.

Normal network traffic Network Congestion



Expandable Network

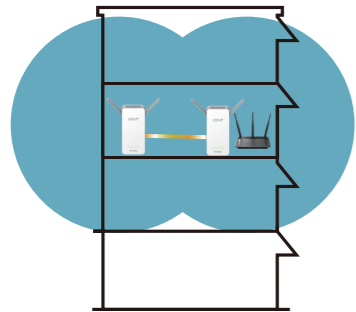

Loft

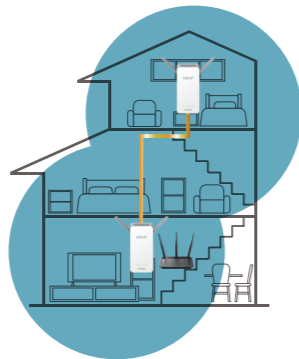

Villa

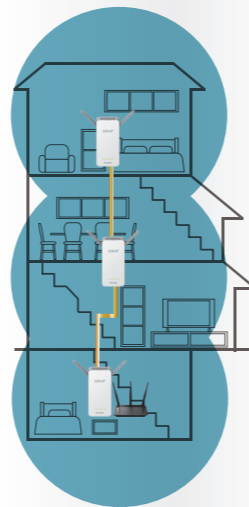

Townhouse



The Covr Hybrid Whole Home Powerline Wi-Fi System is pre-paired and works straight out of the box, so you just need to plug them in and get started. But Covr is also a scalable solution; extra extenders can be added to increase the reach of your network. Not enough coverage upstairs or in the back room? Scale up your whole home network by adding another extender to get true whole-home coverage.

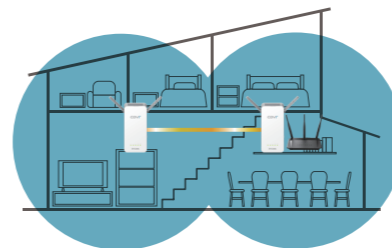

Contemporary

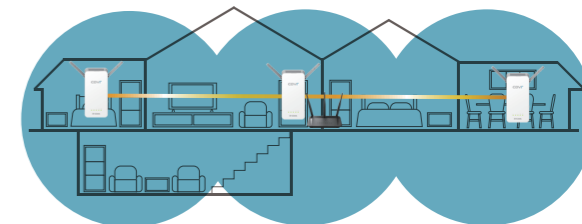

Bungalow

Loft

200m²

300m²

400m²

500m²

600m²

Bungalow



Get to Know Your Covr Devices



Works with your Existing Router

The Covr Hybrid Whole Home Powerline Wi-Fi System works with your existing home router. Simply connect one of the Covr Hybrid Powerline Wi-Fi extenders to one of the Ethernet ports on the back of your router using the included Ethernet cable.





Simple Setup



There are two easy ways to configure your Covr Hybrid Whole Home Powerline Wi-Fi System – Use the free D-Link Wi-Fi app for iOS and Android devices, or use the intuitive web-based setup wizard on your computer. Please see the following pages for further details on how to set up your Covr Hybrid Whole Home Powerline Wi-Fi System using these two methods.

Before You Start

Check the contents of your Covr Hybrid Whole Home Powerline Wi-Fi System with the list on the right.



2 x COVR-P2500 Whole Home Powerline Wi-Fi Extender



Ethernet cable



Wi-Fi configuration card



Set Up Using the D-Link Wi-Fi App

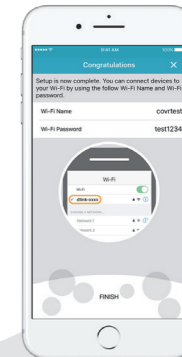
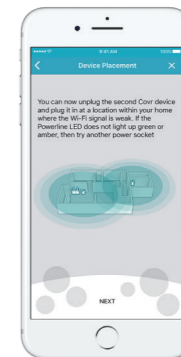
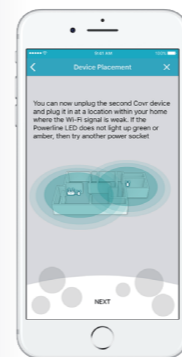
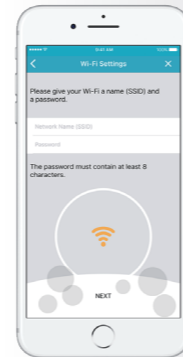
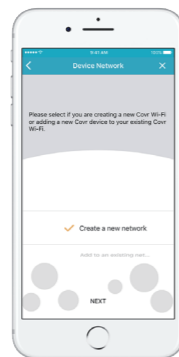
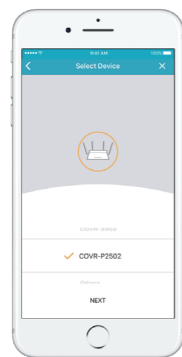

Download the free D-Link Wi-Fi app from the App Store or Google Play.



D-Link Wi-Fi

1. Open the app and tap **Install Your Device**.

2. Select **COVR-P2502** from the model menu and tap **NEXT**.

3. As this is the first time you are setting up a Covr network, select **Create New Covr Network** from the menu and tap **NEXT**.

4. Follow the instructions to plug in your Covr Powerline Wi-Fi Extenders and connect your existing router. During the setup process, you should place the two Covr extenders close to each other. Tap **NEXT** after each step until you reach the screen in Step 5.

5. Set a Network Name (SSID) and Password by entering them in the fields provided. You should try to choose a strong password which is difficult for others to guess. Tap **NEXT** to continue.

6. Set a device (admin) password for your Covr devices. This password is used to access your Covr network's settings through the D-Link Wi-Fi app or web interface. This password should be different from the Wi-Fi network password specified in the previous step. Try to choose a strong password which is difficult for others to guess. You can choose for the D-Link Wi-Fi app to remember your admin password using the slider. Tap **NEXT** to continue.

7. A summary page will show the device password, network name, and network password. You should take note of this information for future reference. Tap **SAVE** to confirm these settings.

8. Device setup is now complete. You can now move the second Covr Powerline Extender to another power outlet where you need additional coverage. Note that if after plugging in the Powerline LED is red or not lit, this may indicate a weak connection, and you should try plugging the extender into another power outlet.

9. A final summary will show your network name and password. Tap **FINISH** to complete the setup. You will be asked if you want to share these details with others. To share device settings, tap **Yes** and then select the method you wish to use to share. Tap **No** if you do not wish to share device settings.



Set Up Using Web Browser

Covr's intuitive setup wizard will guide you through the setup process and have your whole-home network up and running in no time.

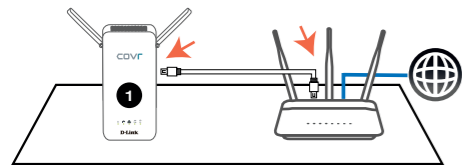

1.

Take the included Ethernet cable and plug one end into one of the LAN ports on the back of your existing router and the other into one of the ports on the side of one of the Covr Powerline Wi-Fi Extenders.

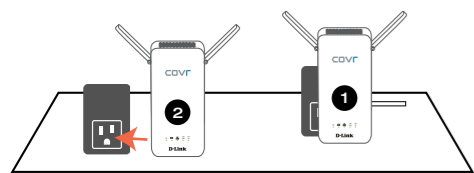

3.

Plug the other Covr Powerline Wi-Fi Extender into a power socket in the location where you want to extend your whole home network to. Wait for the second adapter to power up.

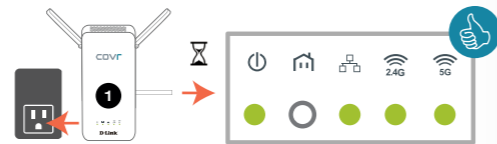

2.

Plug the Covr Powerline Wi-Fi Extender into a power socket. Wait for the device to power up. Once the Power, Network, 2.4G and 5G lights have turned green, continue to the next step.

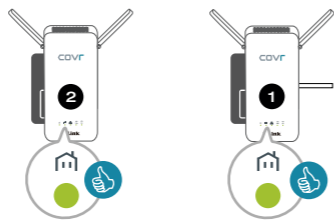

4.

Once the Powerline lights on both adapters have turned green, continue to the next step.



5.

Connect your computer to your existing router using an Ethernet cable or Wi-Fi.

<http://covr.local/>

6.

Type <http://covr.local/> into a web browser and follow the instructions to complete the setup.



7.

The wizard will guide you through the setup process. Click or tap **NEXT** to get started and follow the simple instructions.



Network Management

The Covr Hybrid Whole Home Powerline Wi-Fi System provides you with a home network solution that is quick and easy to set up.

The Powerline adapters work straight out of the box - just plug them in to get started. Configure your network in no time using the intuitive web-based interface or with the free D-Link Wi-Fi app for your Android or iOS mobile device. Adding new wireless devices to your Covr network is a snap thanks to the Wi-Fi Protected Setup (WPS) button, which establishes an instant connection to new devices without the need to enter settings or create passwords. Expand your network with the touch of a button.



Network Status

Click on the Hybrid Powerline Wi-Fi Extender icon to get a snapshot of your network, including device IP address, IPv6 address, and Wi-Fi network status, Wi-Fi Name, and Password.



Powerline

Click the Powerline icon to get the status of the Hybrid Powerline Wi-Fi Extender and see the current Powerline connection speed.

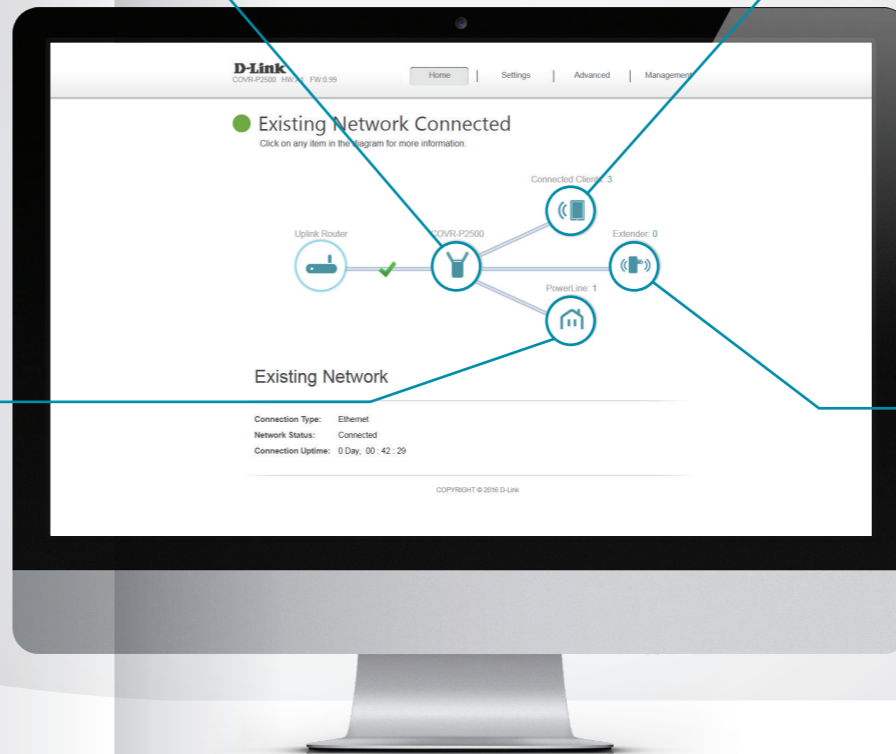

Connected Clients

Check the status of individual devices connected to your Covr network by clicking on this icon. The name and IP address of each device will be displayed in the panel at the bottom of the screen. Click on the edit icon in the top right-hand corner of each device tile to manage that specific device.



Extenders

As you add more extenders to your Covr Whole Home Network, you can check the status of each extender by clicking on this icon. Click on the edit icon for each extender to change its display name. Clients connected to extenders will also be displayed here.

Parental Control and Scheduling

The Parental Control feature can be used to restrict network access to client devices. Schedules can also be set to give client devices access to the whole home network at certain times.

1. First, set up a schedule which can be applied to client devices. From the menu at the top of the home screen click **Management** and then **Time & Schedule**. From the Time & Schedule page, click on the **Schedule** hyperlink to access the scheduling function.

Name:

	0	1	2	3	4	5	6	7	8	9	10	11	12	13	14	15	16	17	18	19	20	21	22	23
Mon								7:00 - 14:00																
Tue								7:00 - 14:00																
Wed														13:00 - 19:00										
Thu								7:00 - 19:00																
Fri										10:00 - 23:00														
Sat															14:00 - 19:00									
Sun															14:00 - 19:00									

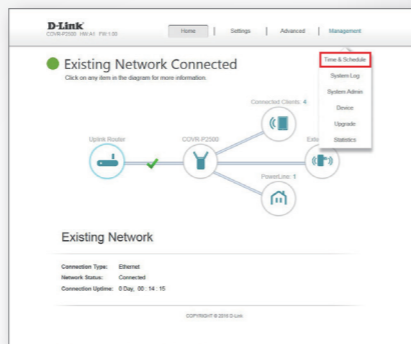

2. Click on **Add Device** to create a new schedule. Enter a name for the new schedule in the **Name** field. Click on a square in the grid to include that time and day combination in the schedule. Click and drag to select a time range. When the desired schedule has been selected, click **Apply** to return to the schedule page. Click the **Save** hyperlink to save the schedule configuration.

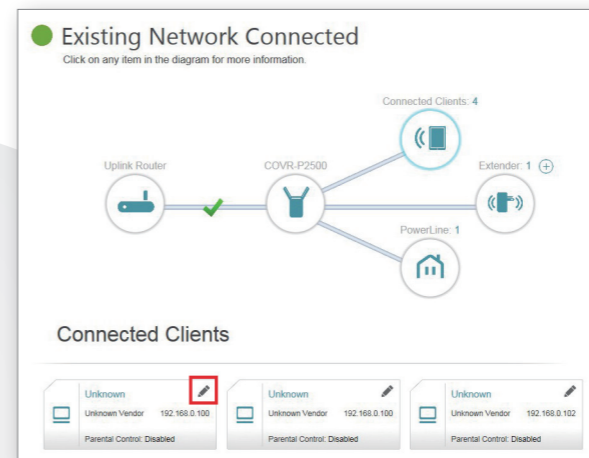

4. In the Edit Rule screen, click the Parental Control slider to enable scheduling, and then select the desired schedule from the drop-down menu. Click **Save** to save the schedule settings for that device.

Edit Rule

Name:

Vendor: CIMSYS

MAC Address: 00:11:22:33:44:56

IP Address: 192.168.0.102

Parental Control: Enabled

Schedule:

- Always OFF
- Schedule 1

3. Return to the home screen and click on the **Connected Clients** icon in the network map. Select the client device which you wish to apply the schedule to by clicking on the pencil icon in the top right-hand corner of the device tile at the bottom of the screen.



COVR-P2500



Specifications

COVR-P2500

Ethernet Ports	3 x Gigabit LAN
Antennas	2 x External
Wi-Fi Data Signal Rate	Up to 866 Mbps (5 GHz) / Up to 300 Mbps (2.4 GHz)
Powerline Standard	HomePlug AV2 1300 Mbps MU-MIMO
Dimensions	140 x 68 x 47 mm (antennas retracted) 5.51 x 2.68 x 1.85 in (antennas retracted)
WPS	Yes
Coverage Area	Up to 450 sqm / 4800 sq. ft.

Features

- Qualcomm® SON technology for seamless roaming
- 802.11ac wave 2 dual-band wireless
- Combined speeds of up to AC1200
- MU-MIMO
- Three Gigabit LAN ports per device
- HomePlug AV2 1300



HIGH
PERFORMANCE



MORE
COVERAGE



ONE SEAMLESS
NETWORK



Covr your
Whole Home in
Seamless
Wi-Fi

